

# DS-PD2-T10P-WEH

Wireless 10m Pet Immune PIR Detector UD09719B-A



START

## ENGLISH

### Diagram References

- 1 PCB Overview
- 2 LED Indications
- 3 Microwave Adjustment: 0m to 15m
- 4 Dip Switched 1-4
- 5 Registration

Please register the device within 90 seconds after it being powered on.

#### Register Locally

1. Make the security control panel enter the registration mode.
2. Register the detector: Hold the registration key until the three LEDs flash alternately. The green LED will flash 8 times if the registration is finished.
3. Communication Test: Release the TAMPER spring to trigger the alarm. Note: The distance between the security control panel and the detector should be less than 50 cm.

#### Initialize the Detector

1. Remove the battery to power the detector off.
2. 5s later, hold the registration key and reinstall the battery to power the detector on at the same time to make the three LEDs start flashing alternately. Release the registration key while the three LEDs flash once together.

#### Register Via APP

1. Log in to the APP Store and input "Hik-Connect" to search the mobile client. Download and install Hik-Connect to your phone.
2. After installing, tap to run the client.
3. Power on the security control panel.
4. Log in the Hik-Connect and tap the icon "+" at the upper-right corner of the Hik-Connect page to add the security control panel. You can scan the QR code on the device rear panel or on the package box, or input the device serial No. manually to add the device when the device is in the registration mode.
5. After adding the security control panel, tap the arming status icon on the right of the security control panel's name to enter the Partition page.
6. Tap the "+" icon on Partition page to add the peripherals.

#### 6 Signal Strength Test

#### 7 Inserting the Fixed Mask or Flexible Mask

#### 8 Flexible Mask Adjustment(1)

#### 9 Flexible Mask Adjustment(2)

#### 10 10m Lens Diagram

#### 11 Wall Mounting Bracket & Adapter

#### 12 Wall Mounting Bracket

#### 13 Fixed Bracket

#### 14 Guidelines

### Technical Specification

Detectors Technical Characteristics	
Detection Range	10m
Detection Angle	90°
Detection Zones	78 zones and 5 planes
Detection Speed	0.25-3m/s
Mounting Height	1.8-2.4m
Two-way Wireless Technology	Yes
Blue Wave Technology	Yes
Dual Element Pyroelectric Sensor	Yes
Tamper Protection	Front, rear, and bracket tamper signal input
Integrated Walk Test Buzzer	Yes
Separated LED Indication	Top: Microwave, PIR 1 and alarm Bottom: PIR 2
Signal Strength Indicators (SSI)	Yes
3 Microwave Frequencies to Avoid Interference	Yes
Digital Independent Floating Threshold(IFT) Technology	Yes
Plastic Housing	Polycarbonate
Animal Immunity	10kg
Optics	Sealed
Adjustable Sensitivity	High or low range
Lens	0.4mm HDPE in lens area
Detection Method	UV compensated
Sensor	2 low noise dual element passive infrared sensors and a microwave doppler unit
Environmental and Operating Features	
Weatherproof	IP55 rated
Certified Operating Temperature	-25°C ~ +60°C (Certified)
Physical Dimensions(H x W x D)	180mm x 80mm x 105mm
Weight	500g
Electrical & battery	
Transmission Frequency	433MHz, FM transceiver
Range in Open Space	800m
Battery Type	2x3V Lithium battery (included)
Accessories	
Rotatable Wall Mounted	Yes - additional wall and fixed brackets available separately
Fixed Wall Mounted	Yes - additional wall and fixed brackets available separately
Ceiling Mounted	Yes - additional wall and fixed brackets available separately
Battery	Additional Battery available separately

### Battery Information

The batteries supplied have been chosen to provide long service life whilst, for safety reasons, having limited output current.

The battery leads must be connected for operation. When disposing of the product, the battery must be removed and disposed of separately in accordance with the local regulations.

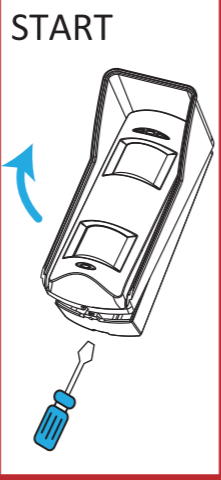

1

2 x 3.0V  
Lithium  
4700mAh

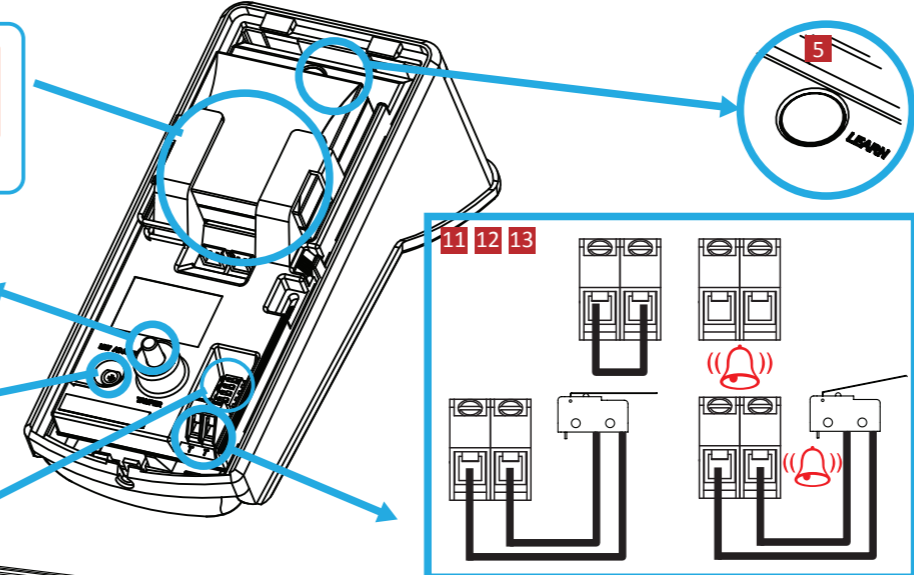

2



- Powering Up
- Low Battery
- Top PIR Activated
- Microwave Activated
- Bottom PIR Activated
- Alarm / Allarme

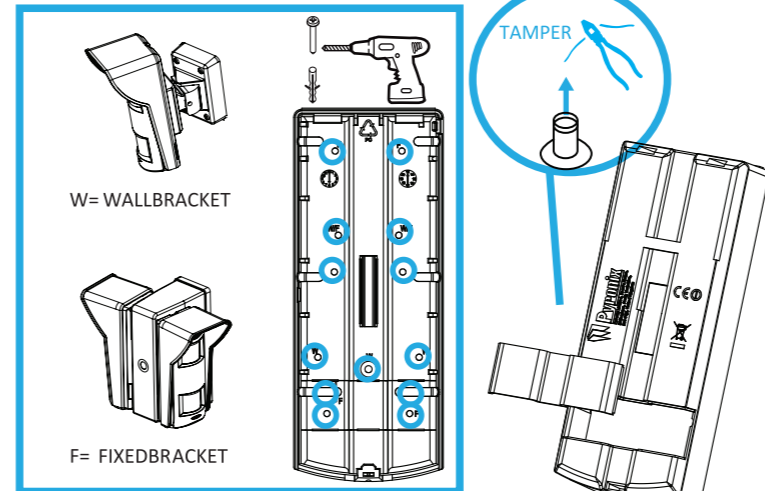
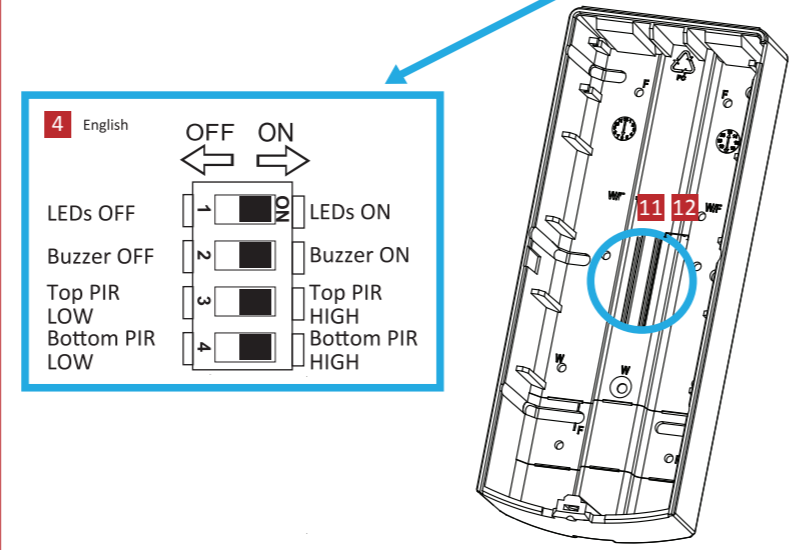

3

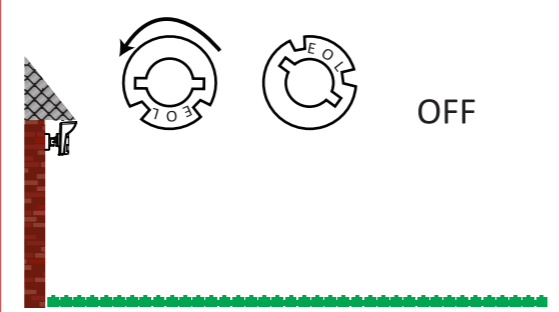
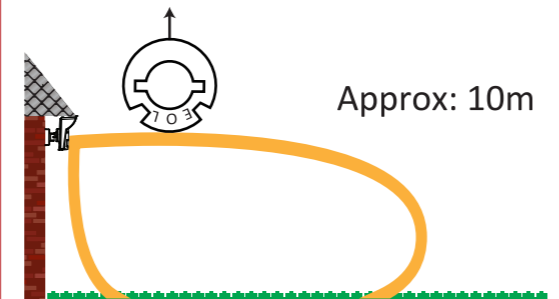
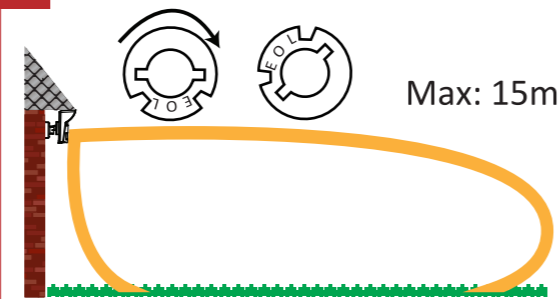

4

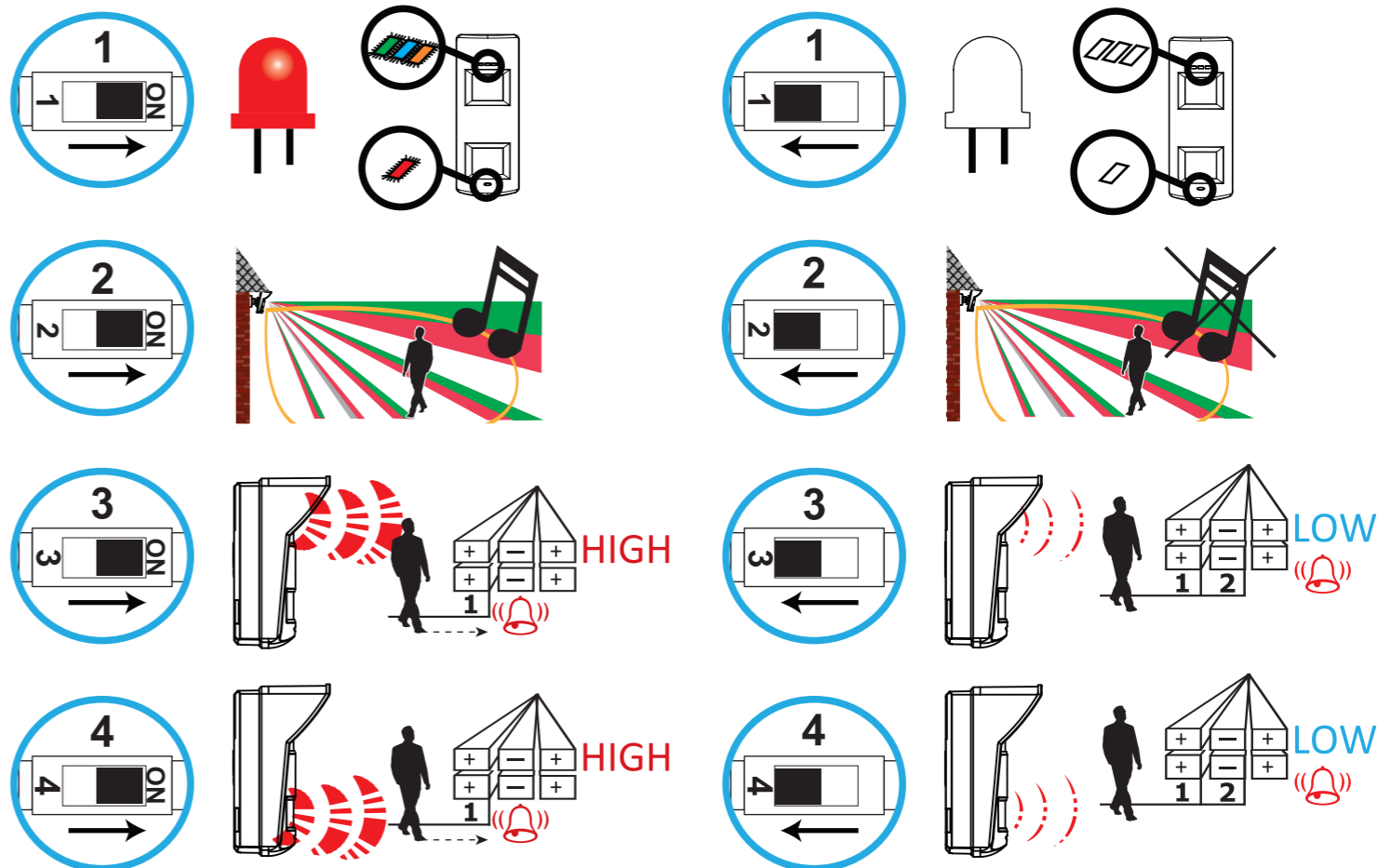

5

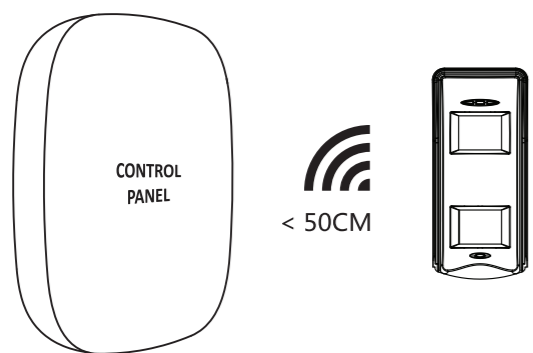

6

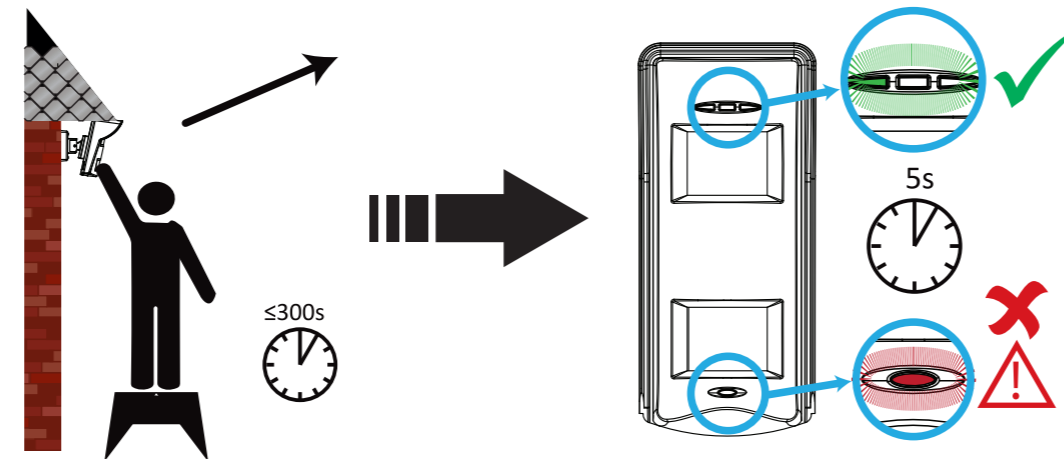

9

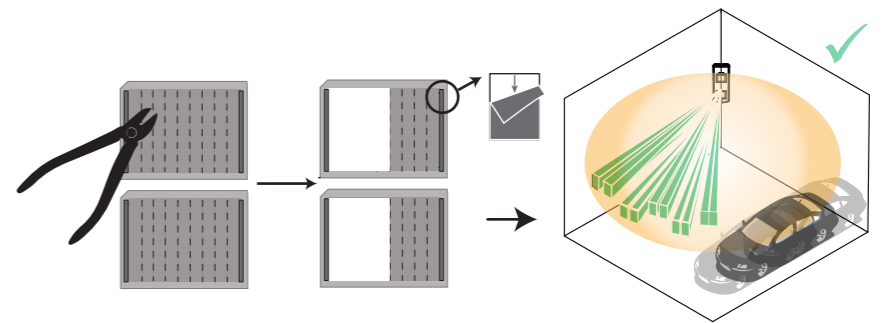

7

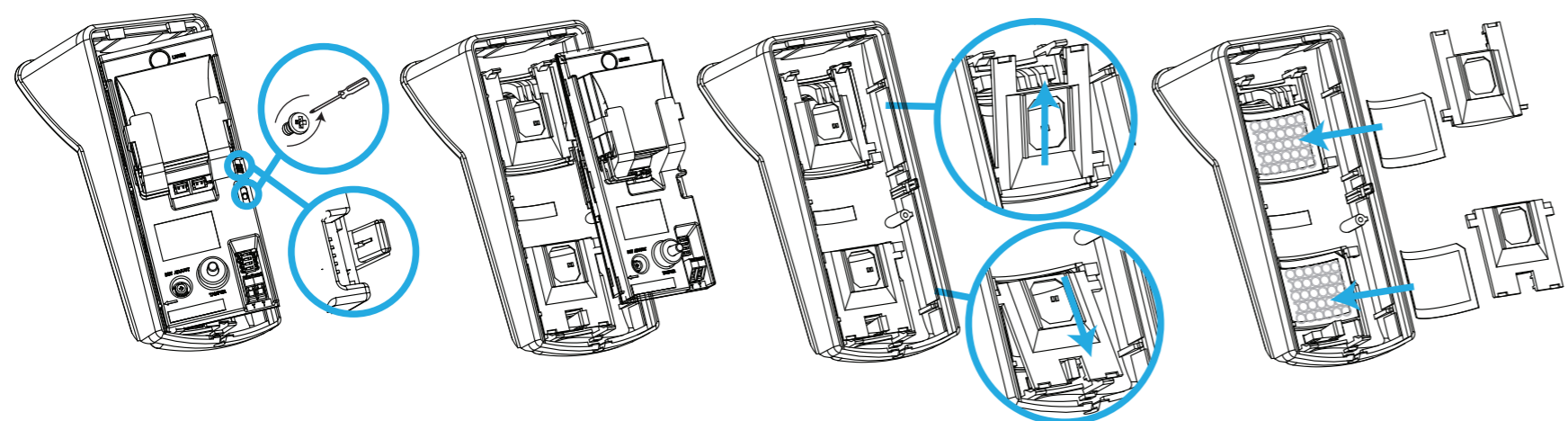

10

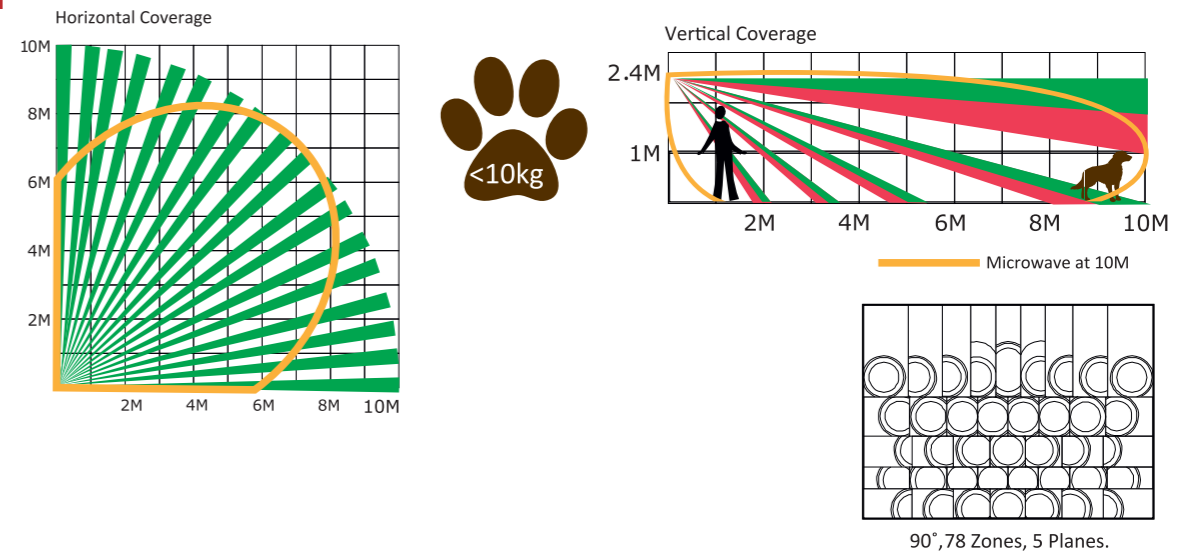

11

WALLBRACKET + ADAPTER

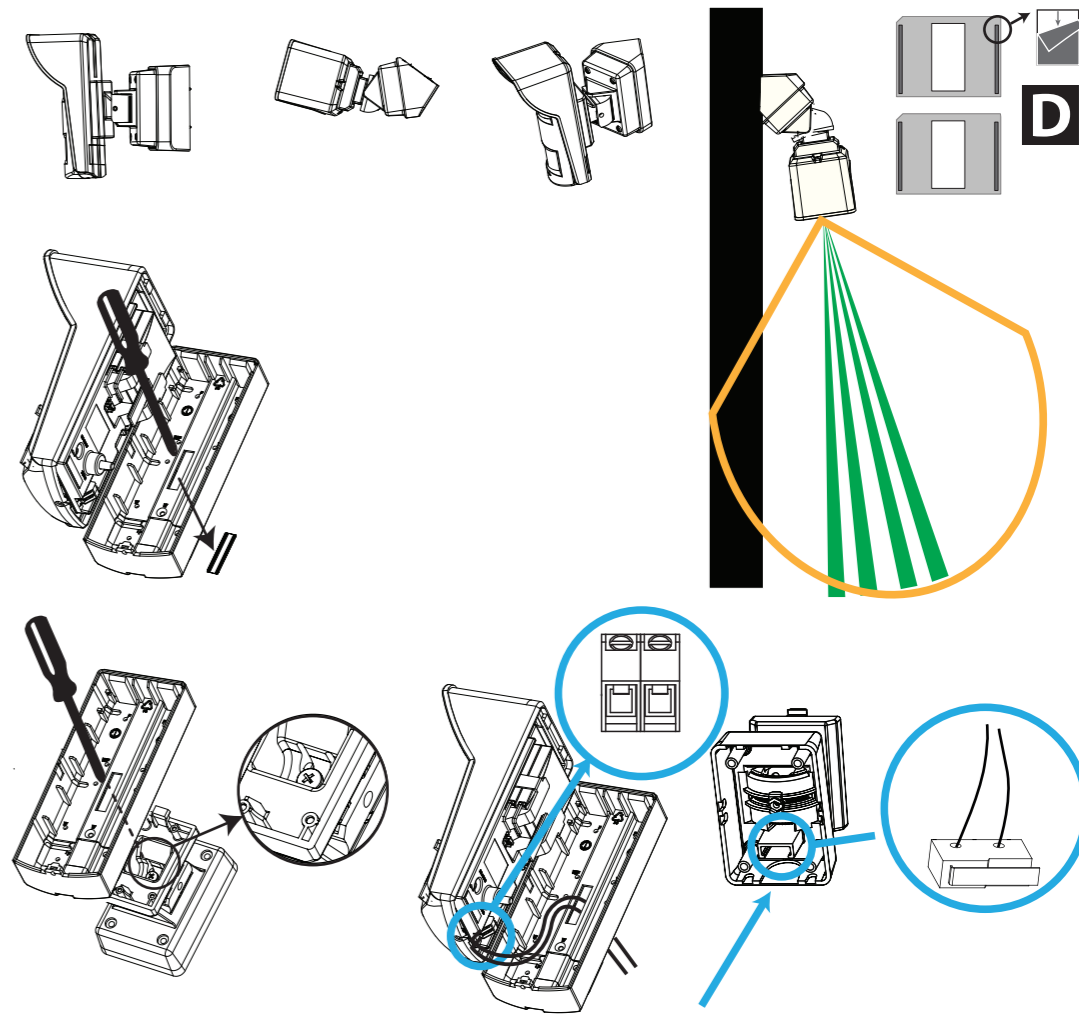

8

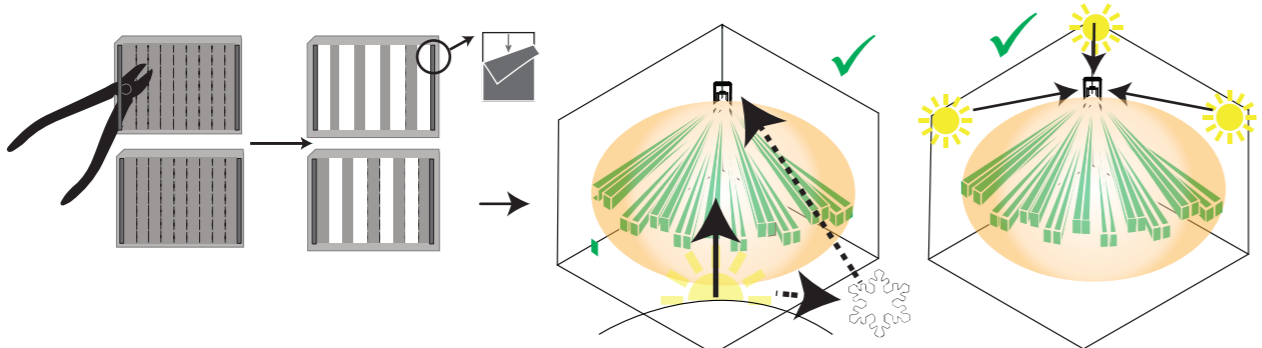

12

WALLBRACKET

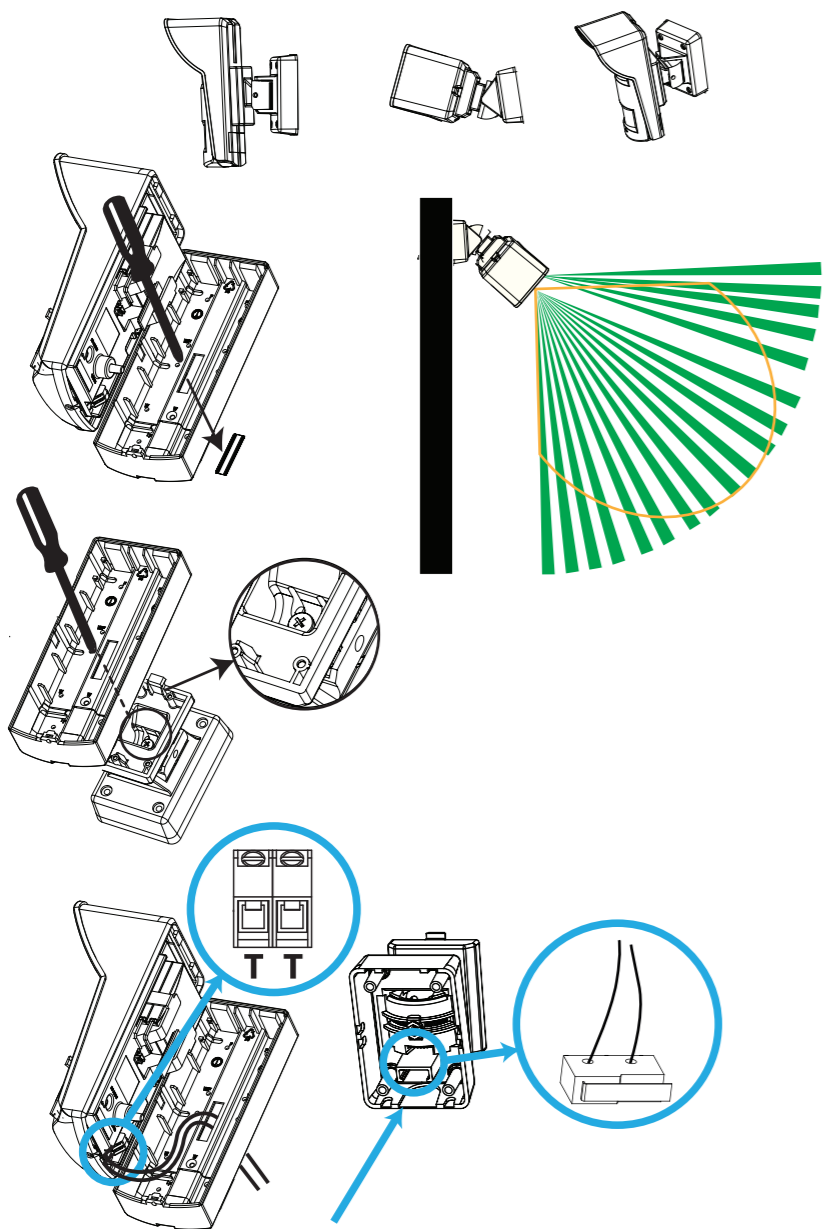

13

FIXEDBRACKET

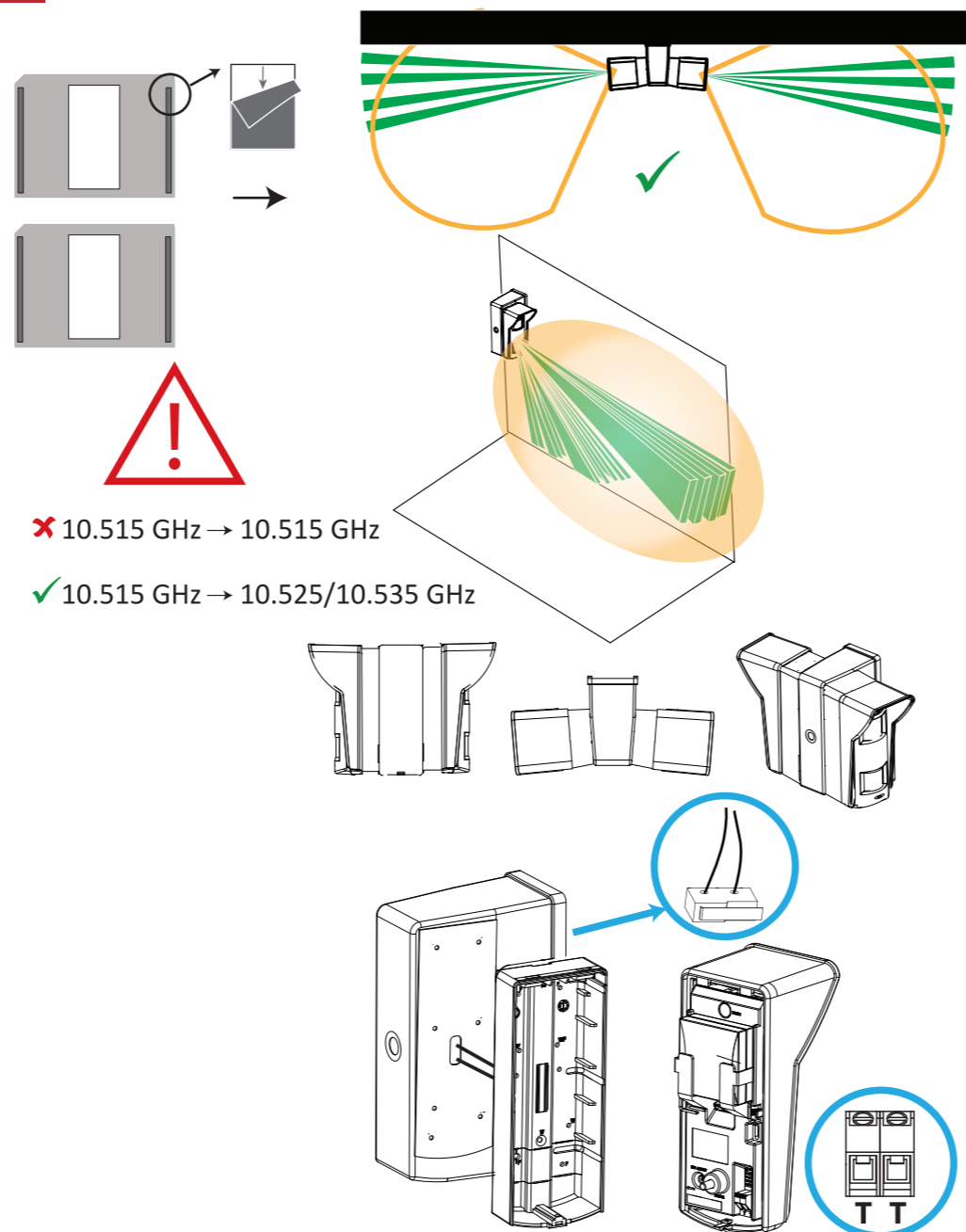

Product Information

User Manual  
 COPYRIGHT © 2018 Hangzhou Hikvision Digital Technology Co., Ltd.  
 ALL RIGHTS RESERVED.  
 Any and all information, including, among others, wordings, pictures, graphs are the properties of Hangzhou Hikvision Digital Technology Co., Ltd. or its subsidiaries (hereinafter referred to be "Hikvision").  
 This user manual (hereinafter referred to be "the Manual") cannot be reproduced, changed, translated, or distributed, partially or wholly, by any means, without the prior written permission of Hikvision.  
 Unless otherwise stipulated, Hikvision does not make any warranties, guarantees or representations, express or implied, regarding to the Manual.  
 About this Manual  
 This manual is applicable to detector.  
 The Manual includes instructions for using and managing the product. Pictures, charts, images and all other information hereinafter are for description and explanation only. The information contained in the Manual is subject to change, without notice, due to firmware updates or other reasons. Please find the latest version in the company website (<http://overseas.hikvision.com/en/>). Please use this user manual under the guidance of professionals.  
 Trademarks Acknowledgement  
**HIKVISION** and other Hikvision's trademarks and logos are the properties of Hikvision in various jurisdictions. Other trademarks and logos mentioned below are the properties of their respective owners.

FCC Information

Please take attention that changes or modification not expressly approved by the party responsible for compliance could void the user's authority to operate the equipment.  
 FCC compliance: This equipment has been tested and found to comply with the limits for a Class B digital device, pursuant to part 15 of the FCC Rules. These limits are designed to provide reasonable protection against harmful interference in a residential installation. This equipment generates, uses and can radiate radio frequency energy and, if not installed and used in accordance with the instructions, may cause harmful interference to radio communications. However, there is no guarantee that interference will not occur in a particular installation. If this equipment does cause harmful interference to radio or television reception, which can be determined by turning the equipment off and on, the user is encouraged to try to correct the interference by one or more of the following measures:  
 -Reorient or relocate the receiving antenna.  
 -Increase the separation between the equipment and receiver.  
 -Connect the equipment into an outlet on a circuit different from that to which the receiver is connected.  
 -Consult the dealer or an experienced radio/TV technician for help.  
 This equipment should be installed and operated with a minimum distance 20cm between the radiator and your body.  
 FCC Conditions  
 This device complies with part 15 of the FCC Rules. Operation is subject to the following two conditions:  
 1. This device may not cause harmful interference.  
 2. This device must accept any interference received, including interference that may cause undesired operation.

14

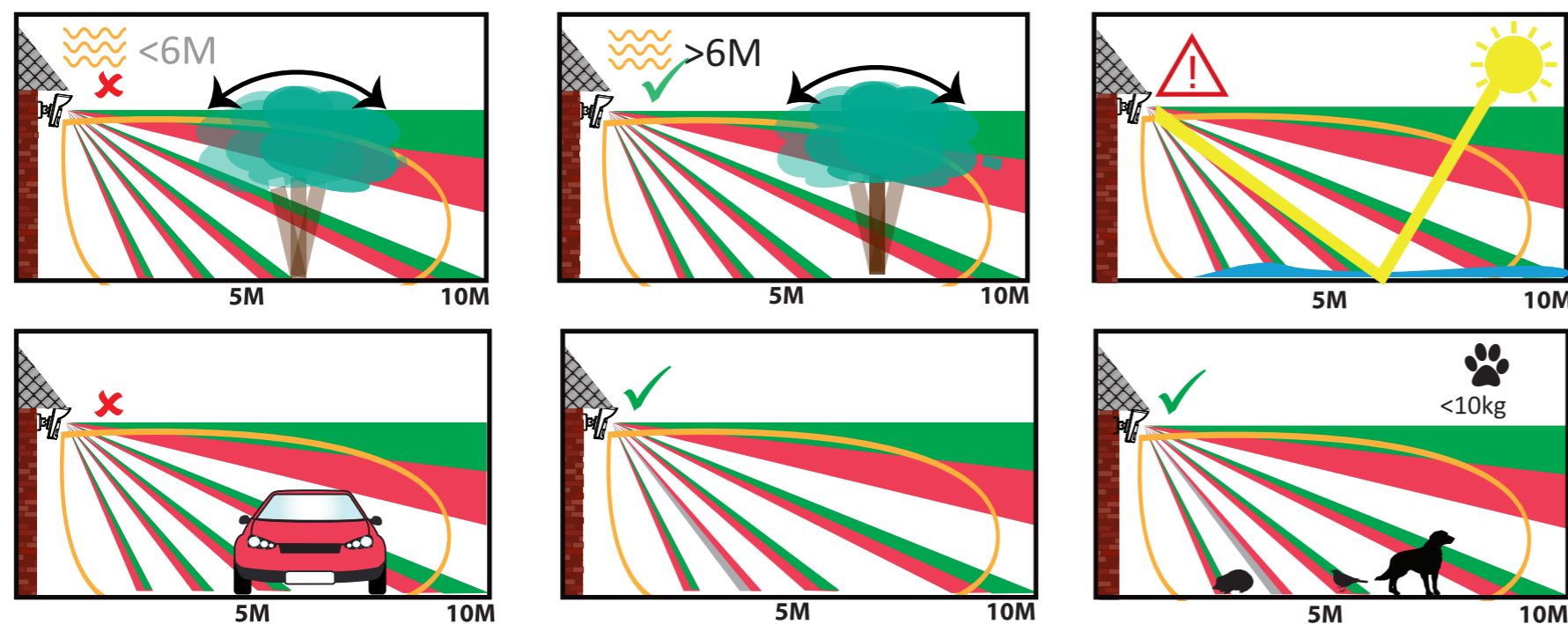

**CE** This product and - if applicable - the supplied accessories too are marked with "CE" and comply therefore with the applicable harmonized European standards listed under the RE Directive 2014/53/EU, the RoHS Directive 2011/65/EU.

For electrical products sold within the European Community. At the end of the electrical products life, it should not be disposed of with household waste. Please recycle where facilities exist. Check with your local Authority or retailer for recycling advice in your country.

This product operates in a European non-harmonised frequency band.

## FRANÇAIS

### Références du schéma

- 1 Vue d'ensemble du PCB
- 2 LED indicatrices
- 3 Ajustement des micro-ondes : 0 à 15 m
- 4 Microcommutateurs 1-4
- 5 Inscription

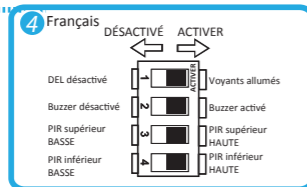

Veillez inscrire l'appareil dans un délai de 90 secondes après sa mise en route.

**Inscription locale**

1. Accéder au mode inscription sur le panneau de commande de sécurité.
2. Inscription du détecteur : Maintenez enfoncée la touche d'inscription jusqu'à ce que les trois voyants clignotent en alternance. Le voyant vert clignote 8 fois si l'inscription est terminée.
3. Test de communication : Relâchez le ressort anti-sabotage pour déclencher l'alarme.

Remarque : La distance entre le panneau de commande sécurité et le détecteur doit être inférieure à 50 cm.

#### Initialisation du détecteur

1. Retirez la batterie pour éteindre le détecteur.
2. 5 secondes plus tard, maintenez enfoncée la touche d'inscription et réinstallez la batterie pour mettre en route le détecteur en même temps pour que les trois voyants commencent à clignoter en alternance. Relâchez la touche d'inscription pendant que les trois voyants clignotent une fois ensemble.

#### Inscription sur l'application

1. Connectez-vous à l'App Store et saisissez « Hik-Connect » pour rechercher le client mobile. Téléchargez et installez Hik-Connect sur votre téléphone.
2. Après l'installation, appuyez sur pour exécuter le client.
3. Allumez le panneau de commande de sécurité.
4. Connectez-vous à Hik-Connect et appuyez sur l'icône « + » dans le coin supérieur droit de la page Hik-Connect pour ajouter le panneau de commande de sécurité. Vous pouvez scanner le code QR sur la paroi arrière de l'appareil ou sur la boîte de l'appareil, ou saisir manuellement le numéro de série de l'appareil pour ajouter l'appareil lorsque l'appareil est en mode inscription.
5. Après avoir ajouté le panneau de commande de sécurité, appuyez sur l'icône d'état d'armement à droite du nom du panneau de commande de sécurité pour accéder à la page Partition.
6. Appuyez sur l'icône « + » dans la page Partition pour ajouter les périphériques.

- 6 Test de force du signal
- 7 Insérer un masque fixe ou flexible
- 8 Ajustement du masque flexible (1)
- 9 Ajustement du masque flexible (2)
- 10 Schéma de l'objectif 10 m
- 11 Support de montage mural et adaptateur
- 12 Support de montage mural
- 13 Support fixe
- 14 Directives

## Spécifications techniques

### Caractéristiques techniques du détecteur

Portée de détection : 10 m  
 Angle de détection : 90°  
 Zones de détection : 78 zones et 5 plans  
 Vitesse de détection : 0,25-3 m/s  
 Hauteur de fixation : 1,8-2,4 m  
 Technologie bidirectionnelle sans fil  
 Technologie Blue Wave  
 Capteur pyroélectrique à deux éléments  
 Protection anti-sabotage Entrée du signal antisabotage avant, arrière et support  
 Avertisseur de test de fonctionnement intégré  
 Indication lumineuse séparée Partie supérieure : Micro-ondes, PIR 1 et alarme | Partie inférieure : PIR 2  
 3 fréquences micro-ondes pour éviter les interférences  
 Technologie à seuils flottants indépendants numériques (IFT)  
 Boîtier en plastique : Polycarbonate  
 Immunité aux animaux : 10 kg  
 Optiques : Scellées  
 Sensibilité réglable : Plage élevée ou basse ; HDPE de 0,4 mm dans la zone de l'objectif  
 Lentille : UV compensé

Méthode de détection : Logique de détection à trois signaux  
 Capteur : 2 capteurs infrarouges passifs à deux éléments faible bruit et 1 capteur Doppler à micro-ondes

### Caractéristiques environnementales et de fonctionnement

Résistant aux intempéries : Classé IP55  
 Température de fonctionnement certifiée : -25 °C à +60 °C (certifiée)  
 Dimensions physiques (H x L x P) : 180 mm x 80 mm x 105 mm  
 Poids : 500 g

### Caractéristiques électriques et batterie

Fréquence de transmission : Émetteur-récepteur FM (433 MHz)  
 Portée en espace dégagé : 800 m  
 Type de batterie : 2 batteries au lithium de 3 V (incluses)  
**Accessoires**  
 Supports fixes et murs supplémentaires disponibles séparément  
 Piles : Batterie supplémentaire disponible séparément

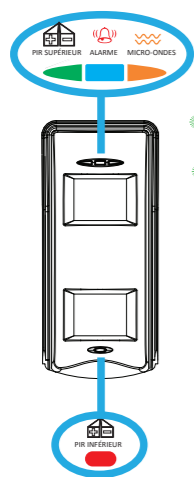

- Mise sous tension
- Batterie faible
- PIR supérieur activé
- Micro-ondes activées
- PIR inférieur activé
- Alarme

## PORTUGUÊS

### Referências do diagrama

- 1 Visão geral do PCB
- 2 Indicações dos LEDs
- 3 Ajuste do micro-ondas: 0 a 15 m
- 4 Chaves DIP Switch 1-4
- 5 Registro

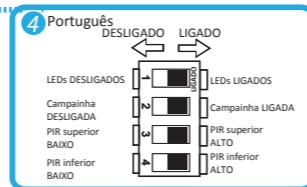

Registre o dispositivo dentro de 90 segundos depois de ele ser ligado.

**Registrar localmente**

1. Coloque o painel de controle de segurança no modo de registro.
2. Registre o detector: mantenha pressionada a tecla de registro até que os três LEDs pisquem alternadamente. O LED verde piscará 8 vezes quando o registro for concluído.
3. Teste de comunicação: solte a mola de VIOLAÇÃO para acionar o alarme.

Observação: a distância entre o painel de controle de segurança e o detector deve ser menor do que 50 cm.

#### Inicializar o detector

1. Remova a bateria para desligar o detector.
2. Cinco segundos depois, mantenha pressionada a tecla de registro e, ao mesmo tempo, reinstale a bateria para ligar o detector, o que fará com que os três LEDs comecem a piscar alternadamente. Solte a tecla de registro quando os três LEDs piscarem juntos ao mesmo tempo.

#### Registrar pelo app

1. Entre na loja de aplicativos e digite "Hik-Connect" para pesquisar o app para celular. Baixe e instale o Hik-Connect no seu telefone.
2. Após a instalação, toque em para executar o app.
3. Ligue o painel de controle de segurança.
4. Faça o login no Hik-Connect e toque no ícone "+" no canto superior direito da página do Hik-Connect para adicionar o painel de controle de segurança. Você pode escanear o código QR no painel traseiro do dispositivo ou na caixa da embalagem, ou inserir o número de série do dispositivo manualmente para adicioná-lo quando ele estiver no modo de registro.
5. Depois de adicionar o painel de controle de segurança, toque no ícone de status do alarme à direita do nome do painel para entrar na página Partição.
6. Toque no ícone "+" na página Partição para adicionar os periféricos.

- 6 Teste de intensidade do sinal
- 7 Inserir a máscara fixa ou a máscara flexível
- 8 Ajuste da máscara flexível (1)
- 9 Ajuste da máscara flexível (2)
- 10 Diagrama da lente de 10 m
- 11 Suporte e adaptador para montagem na parede
- 12 Suporte para montagem na parede
- 13 Suporte fixo
- 14 Instruções

## Especificação técnica

### Características técnicas do detector

Faixa de detecção: 10 m  
 Ângulo de detecção: 90°  
 Zonas de detecção: 78 zonas e 5 planos  
 Velocidade de detecção: 0,25 a 3 m/s  
 Altura de montagem: 1,8 a 2,4 m  
 Tecnologia bidirecional sem fio  
 Tecnologia Blue Wave  
 Sensor piroelétrico de elemento duplo  
 Proteção anti-ativação: entrada de sinal de violação frontal, traseira e do suporte  
 Campanha integrada de teste de caminhada  
 Indicações de LED separadas: superior: micro-ondas, PIR 1 e alarme; inferior: PIR 2  
 Indicadores de intensidade de sinal (SSI)  
 Três frequências de micro-ondas para evitar interferências  
 Tecnologia de limite flutuante independente (IFT) digital  
 Invólucro plástico: polycarbonato  
 Imunidade a animais: 10 kg  
 Óptica: selado  
 Sensibilidade ajustável: faixa maior ou menor; HDPE de 0,4 mm na área da lente  
 Lente: compensação UV

Método de detecção: lógica de detecção de três sinais  
 Sensor: dois sensores infravermelhos passivos de duplo elemento e baixo ruído e uma unidade doppler de micro-ondas

### Características ambientais e operacionais

Exposição ao tempo: classificação IP55  
 Temperatura certificada de operação: -25 °C a +60 °C (certificado)  
 Dimensões físicas (A x L x P): 180 mm x 80 mm x 105 mm  
 Peso: 500 g

### Componentes elétricos e bateria

Frequência de transmissão: 433 MHz, transmissor de FM  
 Alcance em espaço aberto: 800 m  
 Tipo de bateria: 2 x baterias de 3 V de lítio (incluídas)  
**Accessórios**  
 Suportes adicionais de parede e fixo disponíveis separadamente  
 Bateria: bateria adicional disponível separadamente

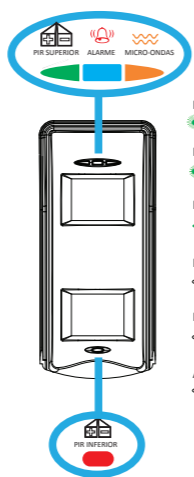

- Ligado
- Bateria fraca
- PIR superior ativado
- Micro-ondas ativado
- PIR inferior ativado
- Alarme

## ITALIANO

### Riferimento schemi

- 1 Panoramica PCB
- 2 LED
- 3 Regolazione microonde: da 0 a 15 m
- 4 Microinterruttori 1-4
- 5 Registrazione

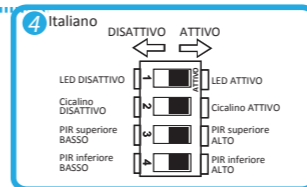

Registare il dispositivo entro 90 secondi dopo l'accensione.

**Registrazione locale**

1. Entrare in modalità di registrazione del pannello di controllo di sicurezza.
2. Registrazione del rilevatore: tenere premuto il tasto di registrazione fino a che i tre LED non lampeggiano alternativamente. Il LED verde lampeggerà 8 volte al termine della registrazione.
3. Test di comunicazione: rilasciare la molla MANOMISSIONE per attivare l'allarme.

Nota: la distanza tra il pannello di controllo di sicurezza e il rilevatore deve essere meno di 50 cm.

#### Inizializzazione del rilevatore

1. Rimuovere la batteria per spegnere il rilevatore.
2. Dopo 5 secondi, premere il tasto di registrazione e reinstallare la batteria allo stesso tempo per accendere il rilevatore e far lampeggiare alternativamente i tre LED. Rilasciare il tasto di registrazione mentre i tre LED lampeggiano insieme una volta.

#### Registrazione tramite APP

1. Accedere all'APP Store e inserire "Hik-Connect" per effettuare la ricerca del client mobile. Scaricare e installare Hik-Connect sul telefono.
2. Dopo l'installazione, toccare per avviare il client.
3. Accendere il pannello di controllo di sicurezza.
4. Accedere a Hik-Connect e toccare l'icona "+" nell'angolo in alto a destra della pagina di Hik-Connect per aggiungere il pannello di controllo. È possibile aggiungere il dispositivo quando è in modalità di registrazione, effettuando la scansione del codice QR situato sul pannello posteriore del dispositivo o sulla scatola della confezione, o inserendo manualmente il numero di serie del dispositivo.
5. Dopo aver aggiunto il pannello di controllo di sicurezza, toccare l'icona dello stato di inserimento, situata a destra del nome del pannello di controllo, per accedere alla pagina Partizioni.
6. Toccare l'icona "+" sulla pagina delle Partizioni per aggiungere le periferiche.

- 6 Test di potenza del segnale
- 7 Inserimento della maschera fissa o flessibile
- 8 Regolamento della maschera flessibile (1)
- 9 Regolamento della maschera flessibile (2)
- 10 Diagramma obiettivo 10 m
- 11 Staffa di montaggio a parete e adattatore
- 12 Staffa di montaggio a parete
- 13 Staffa fissa
- 14 Linee guida

## Specifiche tecniche

### Caratteristiche tecniche del rilevatore

Area di copertura: 10 m  
 Angolo di rilevamento: 90°  
 Zone di rilevamento: 78 zone e 5 piani  
 Velocità di rilevamento: 0,25-3 m/s  
 Altezza di montaggio: 1,8-2,4 m  
 Tecnologia wireless bidirezionale  
 Tecnologia Blue Wave  
 Sensore piroelétrico a due elementi  
 Protezione da manomissioni: ingresso segnale di manomissione anteriore, posteriore e staffa  
 Suoneria di walk test integrata  
 Indicatori LED distinti: Parte superiore: microonde, PIR 1 e allarme; inferiore: PIR 2  
 Indicatore potenza segnale (SSI)  
 3 frequenze a microonde per evitare interferenze  
 Tecnologia IFT (Soglia variabile digitale indipendente)  
 Custodia di plastica: polycarbonato  
 Immunità agli animali: 10 kg  
 Componenti ottici: sigillati  
 Sensibilità regolabile: Intervalli elevati o bassi: 0,4 mm HDPE nell'area dell'obiettivo  
 Obiettivo: con compensazione UV  
 Metodo di rilevazione: logica di rilevamento a tre segnali

Sensore: 2 sensori agli infrarossi passivi a doppio elemento e basso rumore e un'unità doppler a microonde

### Funzionalità operative e ambientali

Resistenza agenti atmosferici: certificato livello IP55  
 Temperatura di esercizio certificata: da -25 °C a +60 °C (certificata)  
 Dimensioni fisiche (A x L x P): 180 mm x 80 mm x 105 mm  
 Peso: 500 g

### Elettricità e batteria

Frequenza di trasmissione: 433 MHz, ricevitore FM  
 Portata in spazi aperti: 800 m  
 Tipo di batteria: 2 batterie al litio da 3 V (incluse)  
**Accessori**  
 Staffe da parete o fisse supplementari disponibili a parte  
 Batteria: batteria supplementare disponibile a parte

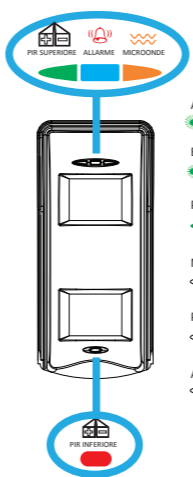

- Accensione
- Batteria scarica
- PIR superiore attivato
- Microonde attivato
- PIR inferiore attivato
- Allarme

## ESPAÑOL

### Referencias del diagrama

- 1 Vista del PCB
- 2 Indicaciones led
- 3 Ajuste de microondas: 0 m a 15 m
- 4 Interruptor DIP 1-4
- 5 Registro

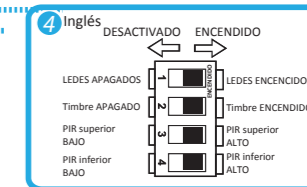

Registre el dispositivo en un periodo de 90 segundos después de encenderlo.

**Registrar localmente**

1. Asegúrese de que el panel de control de seguridad acceda al modo de registro.
2. Registro del detector: Mantenga pulsado el botón de registro hasta que los tres ledes parpadeen alternativamente. El led verde parpadeará 8 veces una vez finalizado el registro.
3. Prueba de comunicación: Suelte el muelle de MANIPULACIÓN para disparar la alarma.

Nota: La distancia entre el panel de control de seguridad y el detector debe ser menor de 50 cm.

#### Inicializar el detector

1. Retire la pila para apagar el detector.
2. 5 s después, mantenga pulsado el botón de registro y vuelva a insertar la pila para encender el detector al mismo tiempo para que los tres ledes empiecen a parpadear alternativamente. Suelte el botón de registro cuando los tres led parpadeen a la vez.

#### Registrar a través de la aplicación

1. Inicie sesión en la App Store y escriba "Hik-Connect" para buscar el cliente móvil. Descargue e instale Hik-Connect en su teléfono.
2. Después de instalarlo, pulse para ejecutar el cliente.
3. Encienda el panel de control de seguridad.
4. Inicie sesión en Hik-Connect y pulse el icono "+" en la esquina superior derecha de la página de Hik-Connect para añadir el panel de control de seguridad. Puede escanear el código QR del panel trasero del dispositivo o del embalaje, o introducir manualmente el número de serie del dispositivo para añadirlo en modo de registro.
5. Después de añadir el panel de control de seguridad, pulse el icono de estado de armado a la derecha del nombre del panel de control de seguridad para acceder a la página de partición.
6. Pulse el icono "+" de la página de partición para añadir los periféricos.

- 6 Prueba de intensidad de señal
- 7 Introducir la máscara fija o flexible
- 8 Ajustes de máscara flexible (1)
- 9 Ajustes de máscara flexible (2)
- 10 Diagrama de las lentes de 10 m
- 11 Soporte de montaje en pared y adaptador
- 12 Soporte de montaje en pared
- 13 Soporte fijado
- 14 Pautas

## Especificaciones técnicas

### Características técnicas de los detectores

Lentes: Compensación UV  
 Impermeabilidad: Calificación IP55  
 Método de detección: Lógica de detección de señal triple  
 Sensor: 2 sensores infrarrojos pasivos de doble elemento y bajo ruido y una unidad Doppler microondas  
**Características ambientales y de funcionamiento**  
 Impermeabilidad: Calificación IP55  
 Temperatura de funcionamiento certificada: -25 °C a +60 °C (certificado)  
 Dimensiones físicas (alto x ancho x profundidad): 180 mm x 80 mm x 105 mm  
 Peso: 500 g  
**Electricidad y pila**  
 Frecuencia de transmisión: 433 MHz, transmisor FM  
 Alcance en espacios abiertos: 800 m  
 Tipo de batería: 2 pilas de litio de 3 V (incluidas)  
**Accessorios**  
 Soportes de pared y fijos adicionales disponibles por separado  
 Batería: Pila adicional disponible por separado

Método de detección: Lógica de detección de señal triple  
 Sensor: 2 sensores infrarrojos pasivos de doble elemento y bajo ruido y una unidad Doppler microondas

Exposición al tiempo: clasificación IP55  
 Temperatura de operación certificada: -25 °C a +60 °C (certificado)  
 Dimensiones físicas (alto x ancho x profundidad): 180 mm x 80 mm x 105 mm  
 Peso: 500 g

Alcance en espacio abierto: 800 m  
 Tipo de batería: 2 pilas de litio de 3 V (incluidas)

Soportes de pared y fijos adicionales disponibles por separado  
 Batería: Pila adicional disponible por separado

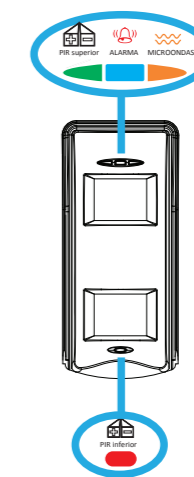

- Encendido
- Batería baja
- PIR superior activado
- Microondas activado
- PIR inferior activado
- Alarma

## РУССКИЙ

### Ссылки на рисунки

- 1 Обзор печатной платы
- 2 Светодиодная индикация
- 3 Регулировка микроволнового датчика:
- 4 от 0 до 15 м
- 5 DIP-переключатель: 1-4

#### Регистрация

Зарегистрируйте устройство в течение 90 секунд после включения питания.

#### Локальная регистрация

1. Включите режим регистрации на панели управления системой безопасности.
2. Регистрация датчика: Нажмите и удерживайте кнопку регистрации, пока три светодиода не начнут мигать поочередно. Когда регистрация будет выполнена, зеленый светодиод мигнет 8 раз.
3. Тестирование связи: Отпустите пружину датчика ВЗЛОМА для активации сигнала тревоги.

Примечание. Расстояние между панелью управления системой безопасности и датчиком должно быть менее 50 см.

#### Инициализация датчика

1. Извлеките батарею для выключения датчика.
2. Через 5 секунд нажмите кнопку регистрации и, удерживая ее, вставьте батарею на место. После этого три светодиода начнут мигать поочередно. Отпустите кнопку регистрации, когда все три светодиода мигнут один раз одновременно.

#### Регистрация с помощью приложения

1. Откройте App Store и введите "Hik-Connect" для поиска мобильного клиента. Скачайте приложение Hik-Connect и установите его на свой телефон.
2. После установки нажмите для запуска клиента.
3. Включите панель управления системой безопасности.
4. Чтобы добавить панель управления системой безопасности, войдите в Hik-Connect и нажмите значок "+" в верхнем правом углу страницы. Когда устройство находится в режиме регистрации, вы можете отсканировать QR-код, который указан на задней панели устройства и на упаковочной коробке, или ввести серийный номер устройства вручную, чтобы добавить это устройство.
5. После добавления панели управления системой безопасности нажмите значок состояния постановки на охрану справа от названия панели, чтобы открыть страницу распределения.
6. Для добавления периферийных устройств нажмите значок "+" на странице распределения.

- 6 Проверка уровня сигнала
- 7 Вставка фиксированной или гибкой маски
- 8 Регулировка гибкой маски (1)
- 9 Регулировка гибкой маски (2)
- 10 Схема объективов, диапазон 10 м
- 11 Кронштейн для настенного монтажа и адаптер
- 12 Кронштейн для настенного монтажа
- 13 Фиксированный кронштейн
- 14 Рекомендации

### Технические характеристики

#### Технические характеристики датчиков

Диапазон обнаружения: 10 м  
Угол обнаружения: 90°  
Зоны обнаружения: 78 зон и 5 плоскостей  
Скорость обнаружения: 0,25–3 м/с  
Монтажная высота: 1,8–2,4 м  
Двухнаправленная беспроводная технология  
Технология Blue Wave  
Двойной элемент пьезоэлектрического датчика  
Защита от взлома: вход сигнала датчиков взлома (переднего, заднего и кронштейна)  
Встроенный зуммер теста ходьбой  
Отдельные светодиоды: Верх: микроволновый датчик, пассивный ИК-датчик 1, сигнал тревоги; низ: пассивный ИК-датчик 2  
Индикаторы уровня сигнала (SSI)  
3 частоты микроволнового излучения для предотвращения помех  
Технология цифровых независимых плавающих порогов  
Пластиковый корпус: поликарбонат  
Отсутствие ложных срабатываний при обнаружении домашних животных: 10 кг  
Оптика: герметичная  
Регулируемая чувствительность: Высокий/низкий диапазон; 0,4 мм HDPE в области объектива  
Линза: компенсация ультрафиолетового излучения

Способ обнаружения: логика распознавания тройным сигналом  
Датчик: 2 маломощных пассивных инфракрасных датчика с двойным элементом и микроволновый доплеровский датчик

#### Эксплуатационные характеристики и характеристики среды

Защита от погодных условий: уровень защиты IP55  
Сертифицированная рабочая температура: от -25 до +60 °C (сертифицировано)  
Физические размеры (В x Ш x Г): 180 мм x 80 мм x 105 мм  
Масса: 500 г

#### Электропитание и батарея

Частота передачи: 433 МГц, FM  
Дальность действия на открытом пространстве: 800 м  
Тип батареи: 2 литиевые батареи, 3 В (прилагаются)

#### Вспомогательное оборудование

Дополнительные настенные и фиксированные кронштейны поставляются отдельно  
Батарея: Дополнительную батарею можно приобрести отдельно

